

**KEY**

- S\* HIGHWAY TO BE STOPPED UP
- H\* HIGHWAY TO BE IMPROVED
- N\* ROUTE OF NEW HIGHWAY
- X\* PRIVATE MEANS OF ACCESS STOPPED UP
- \* NEW PRIVATE MEANS OF ACCESS
- - - - - EXISTING HIGHWAY BOUNDARY
- - - - - PROPOSED HIGHWAY BOUNDARY
- UCR DENOTES UNCLASSIFIED ROAD
- FP. DENOTES PUBLIC FOOTPATH

**General notes**  
**Viewports and inserts**  
Provide a more detailed view at a larger scale.  
**(pt.) \* reference numbers**  
Denotes that only part of that particular SRO reference length is being shown.

MAP REFERRED TO IN THE LEICESTERSHIRE COUNTY COUNCIL  
(NORTH EAST MELTON MOWBRAY DISTRIBUTOR ROAD)  
(SIDE ROADS) ORDER 2020  
SIDE ROADS ORDER PLAN 7A (SECTION PLAN)

|                                      |    |    |          |     |
|--------------------------------------|----|----|----------|-----|
| ACQUIRING AUTHORITIES' MODIFICATIONS | MH | DB | 31/08/21 | C02 |
| FINAL CHECK AND APPROVE ISSUE        | BM | PL | 18/06/20 | A1  |

**PROJECT MANAGEMENT INITIALS**  
DESIGNED: II      CHECKED: AL      APPROVED: DB

**INTERNAL PROJECT NUMBER**      **SCALE**  
60542201      AS SHOWN

**STATUS**      **FINAL**  
PCF STAGE 1 APPROVED      A1

**SHEET TITLE**  
SIDE ROAD ORDERS PLAN 7A  
SECTION PLAN NEMMDR; LAG  
LANE & SAWGATE ROAD

**DRAWING NUMBER**      **06/07**      **REV**  
60542201-LCC-LSI -S5\_SR\_ZZ\_Z -DR-KK-0013      C02

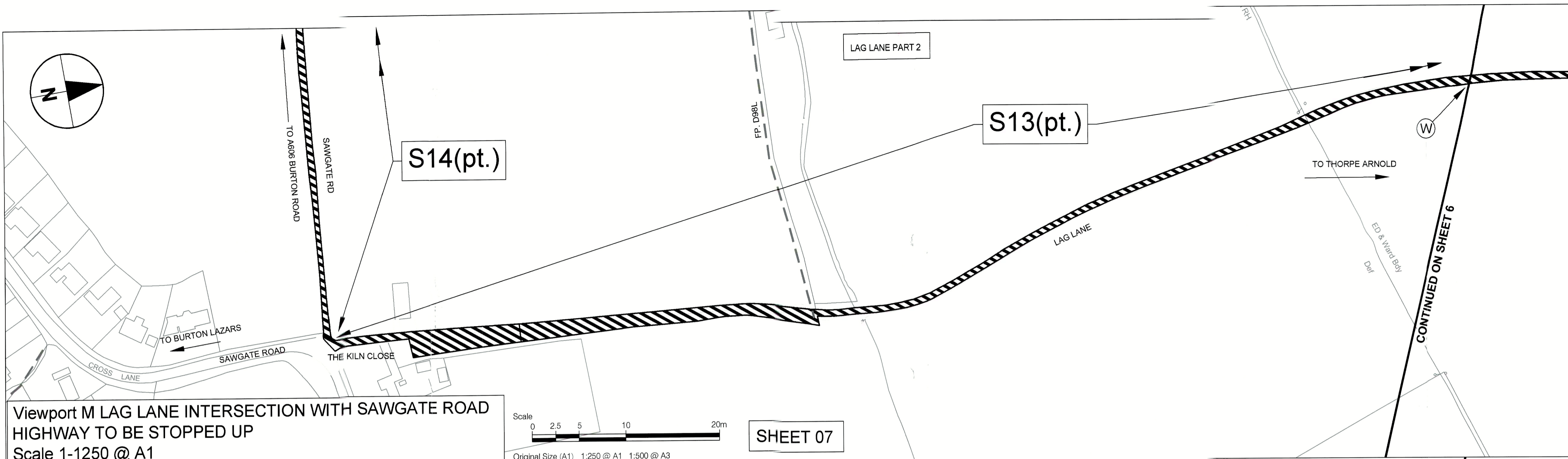

**Viewport M LAG LANE INTERSECTION WITH SAWGATE ROAD  
HIGHWAY TO BE STOPPED UP**  
Scale 1-1250 @ A1

Scale 0 2.5 5 10 20m  
Original Size (A1) 1:250 @ A1 1:500 @ A3  
**SHEET 07**

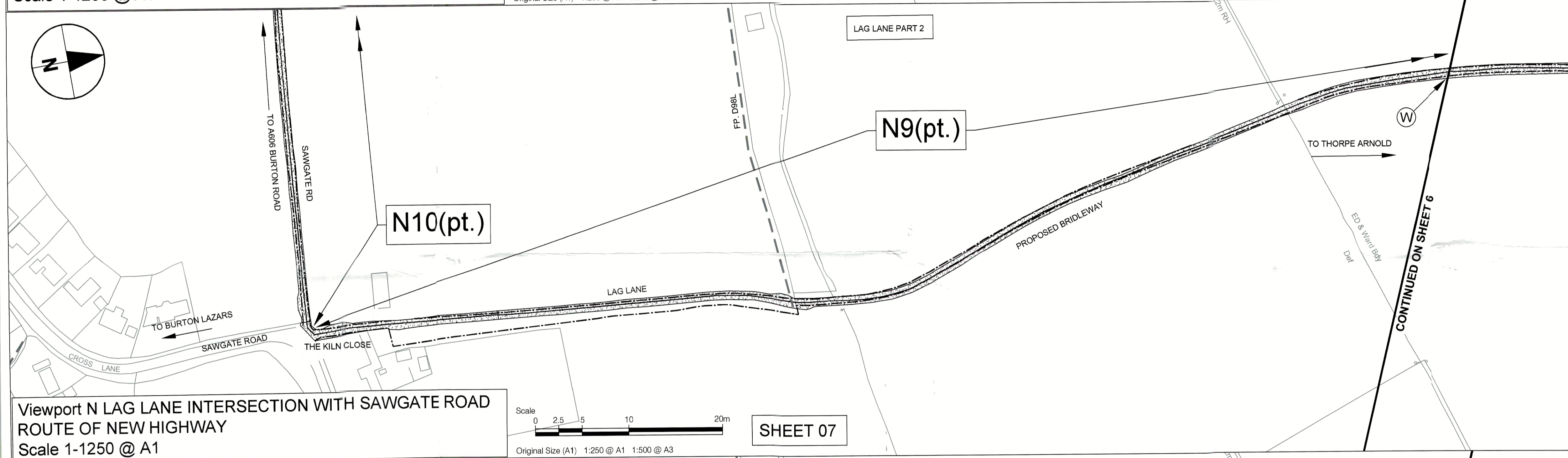

**Viewport N LAG LANE INTERSECTION WITH SAWGATE ROAD  
ROUTE OF NEW HIGHWAY**  
Scale 1-1250 @ A1

Scale 0 2.5 5 10 20m  
Original Size (A1) 1:250 @ A1 1:500 @ A3  
**SHEET 07**

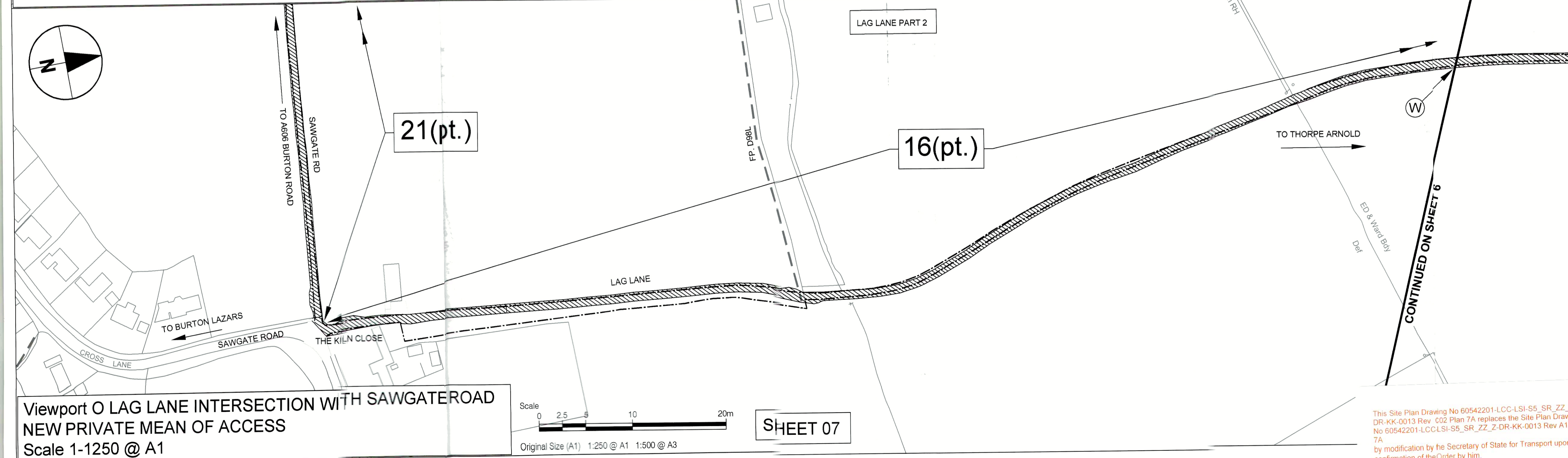

**Viewport O LAG LANE INTERSECTION WITH SAWGATE ROAD  
NEW PRIVATE MEAN OF ACCESS**  
Scale 1-1250 @ A1

Scale 0 2.5 5 10 20m  
Original Size (A1) 1:250 @ A1 1:500 @ A3  
**SHEET 07**

This Site Plan Drawing No 60542201-LCC-LSI-S5\_SR\_ZZ\_Z-DR-KK-0013 Rev C02 Plan 7A replaces the Site Plan Drawing No 60542201-LCC-LSI-S5\_SR\_ZZ\_Z-DR-KK-0013 Rev A1 Plan 7A by modification by the Secretary of State for Transport upon confirmation of the Order by him.