

PROJECT
A606 NORTH & EAST MELTON MOWBRAY DISTRIBUTOR ROAD (NEMMDR)

CLIENT
LEICESTERSHIRE COUNTY COUNCIL

County Hall, Glenfield
 Leicester, LE3 8RA
 tel: +44 (0)116 232 3232
 www.leicestershire.gov.uk

CONSULTANT
AECOM

12 Regan Way
 Chetwynd Business Park
 Chilwell, Nottingham, NG9 6RZ
 tel: +44 (0)115 907 7000
 www.aecom.com

NOTES
 1. ALL DIMENSIONS ARE IN METRES UNLESS STATED OTHERWISE.
 2. THIS DRAWING IS BASED ON ORDNANCE SURVEY DATA AND THE COMBINED AECOM AND LCC TOPOGRAPHICAL SURVEY.

KEY

- HIGHWAY TO BE STOPPED UP
- HIGHWAY TO BE IMPROVED
- ROUTE OF NEW HIGHWAY
- PRIVATE MEANS OF ACCESS STOPPED UP
- NEW PRIVATE MEANS OF ACCESS
- EXISTING HIGHWAY BOUNDARY
- PROPOSED HIGHWAY BOUNDARY
- DENOTES UNCLASSIFIED ROAD
- DENOTES PUBLIC FOOTPATH

General notes
Viewports and inserts
 Provide a more detailed view at a larger scale.
(pt.) * reference numbers
 Denotes that only part of that particular SRO reference length is being shown.

MAP REFERRED TO IN THE LEICESTERSHIRE COUNTY COUNCIL (NORTH & EAST MELTON MOWBRAY DISTRIBUTOR ROAD) (SIDE ROADS) ORDER 2020 (SIDE ROADS ORDER PLAN 6)

ACQUIRING AUTHORITIES' MODIFICATIONS	MH	DB	31/08/21	C02
FINAL CHECK AND APPROVE ISSUE	BM	PL	18/06/20	A1

PROJECT MANAGEMENT INITIALS

DESIGNED: II	CHECKED: AL	APPROVED: DB
INTERNAL PROJECT NUMBER		SCALE
60542201		1:2500
STATUS		FINAL
PCF STAGE 1 APPROVED		A1

SHEET TITLE
 SIDE ROAD ORDERS PLAN 6
 NEMMDR; LAG LANE FROM
 B676 SOUTH OF SYSTON TO
 PETERBOROUGH RAILWAY LINE

DRAWING NUMBER	REV
60542201-LCC-LSI -S5_SR_ZZ_Z	-DR-KK-0006 C02

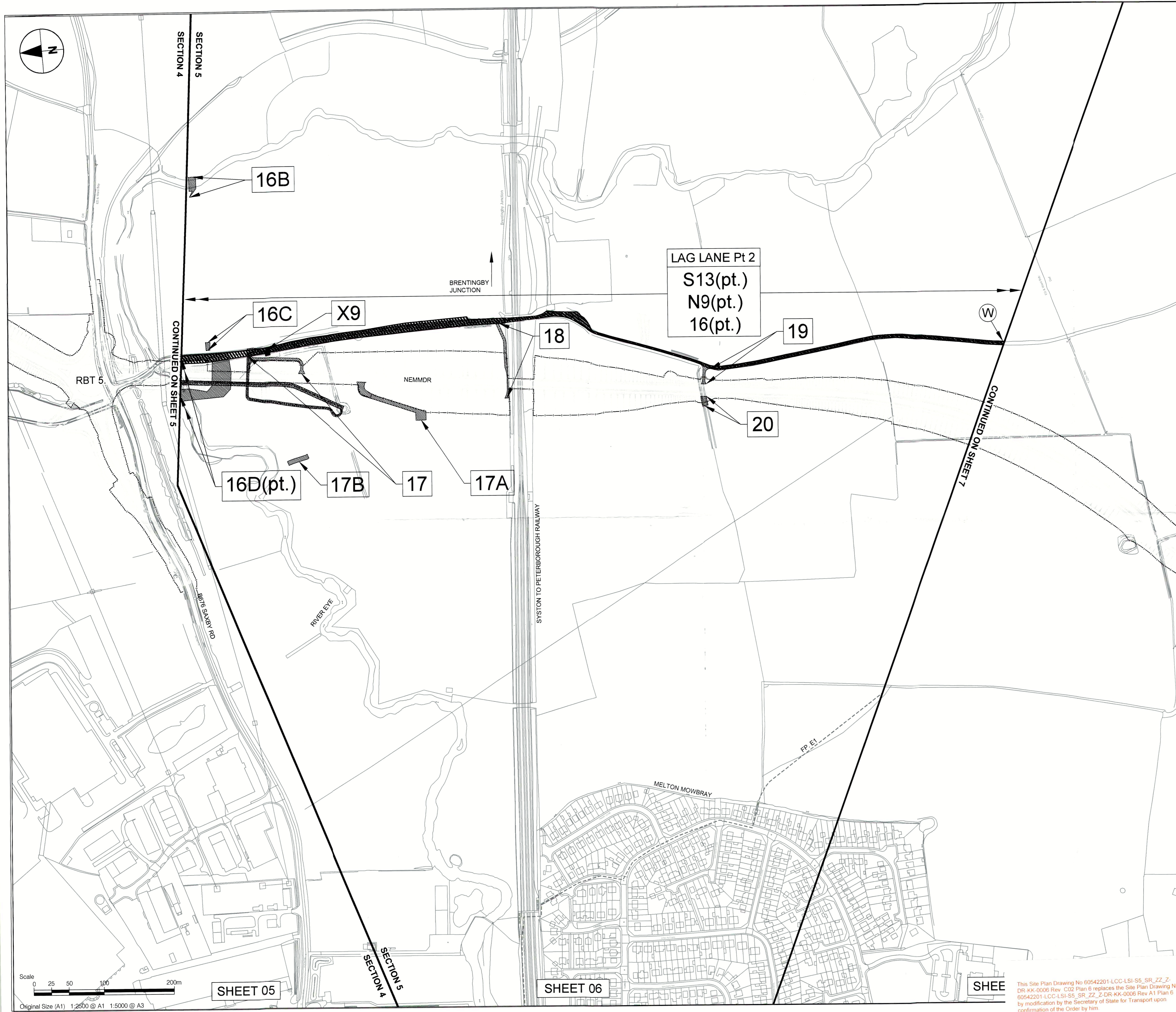

Scale
 0 25 50 100 200m
 Original Size (A1) 1:2500 @ A1 1:5000 @ A3

SHEET 05

SHEET 06

SHEE

This Site Plan Drawing No 60542201-LCC-LSI-S5_SR_ZZ_Z-DR-KK-0006 Rev C02 Plan 6 replaces the Site Plan Drawing No 60542201-LCC-LSI-S5_SR_ZZ_Z-DR-KK-0006 Rev A1 Plan 6 by modification by the Secretary of State for Transport upon confirmation of the Order by him.

JP
 01
 1
 AJ
 ALE
 NG
 NAL
 A1
 REV
 A1