

**LEAD MEMBER  
(ENVIRONMENT AND TRANSPORT)  
MEETING**

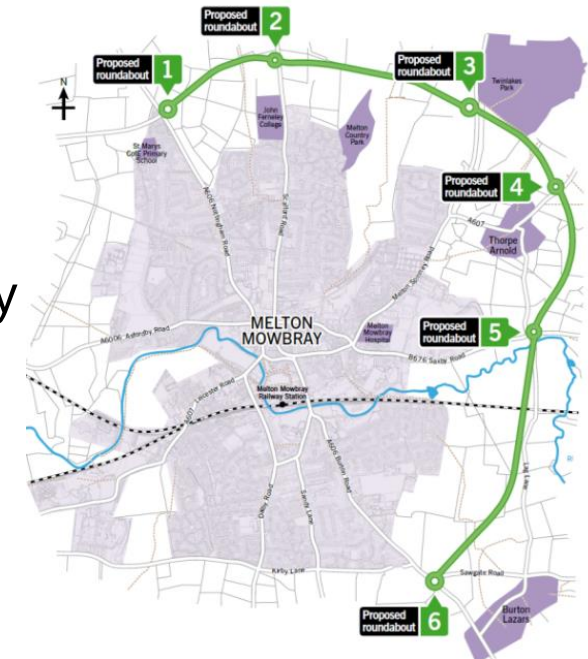
**Melton Mowbray Distributor Road  
Preferred Route**



**8<sup>TH</sup> MAY 2018**

## Decisions taken at the Cabinet Meeting 12 December 2017

- ❑ The recommended route for the northern and eastern sections of the MMDR was agreed for the purposes of further development and consultation
- ❑ Further funding was committed by the County Council (subject to agreement with Melton Borough Council in the form of MOU regarding finance) in order to complete all further work necessary to prepare the scheme for construction by spring 2020
- ❑ Negotiate land purchase with landowners and prepare Compulsory Purchase Orders
- ❑ Make amendments to the recommended route in consultation with relevant parties and delegate authority to the Director and Lead Member for Environment and Transport to agree a Preferred Route.
- ❑ Submit the Outline Business Case to DfT

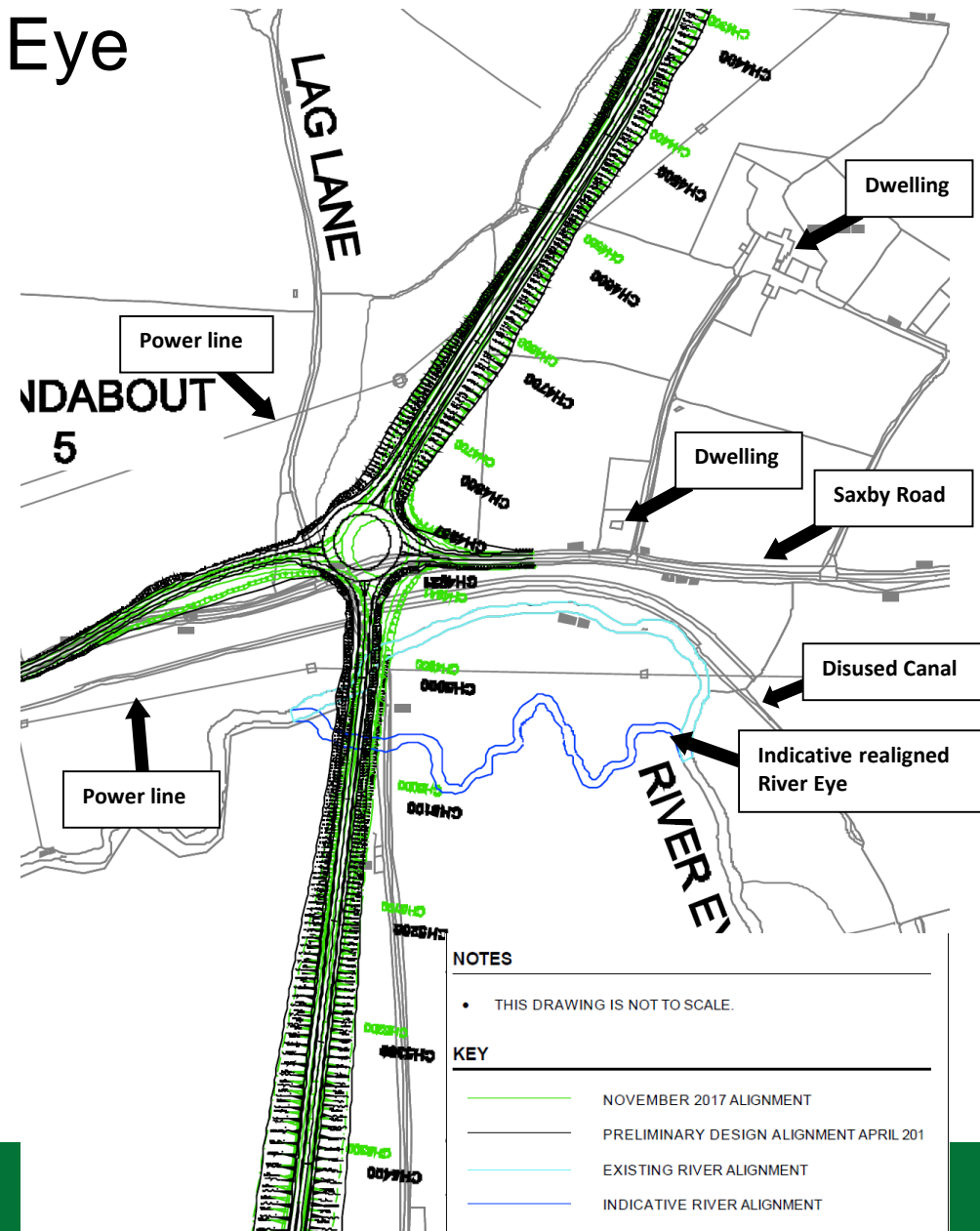


- ❑ Responses to outstanding DfT points of clarification
- ❑ Detailed discussions with statutory consultees – Environment Agency and Natural England
- ❑ Engagement with developers to north of the town
- ❑ Continued engagement with landowners and stakeholders
- ❑ Detailed environmental surveys
- ❑ Further design work

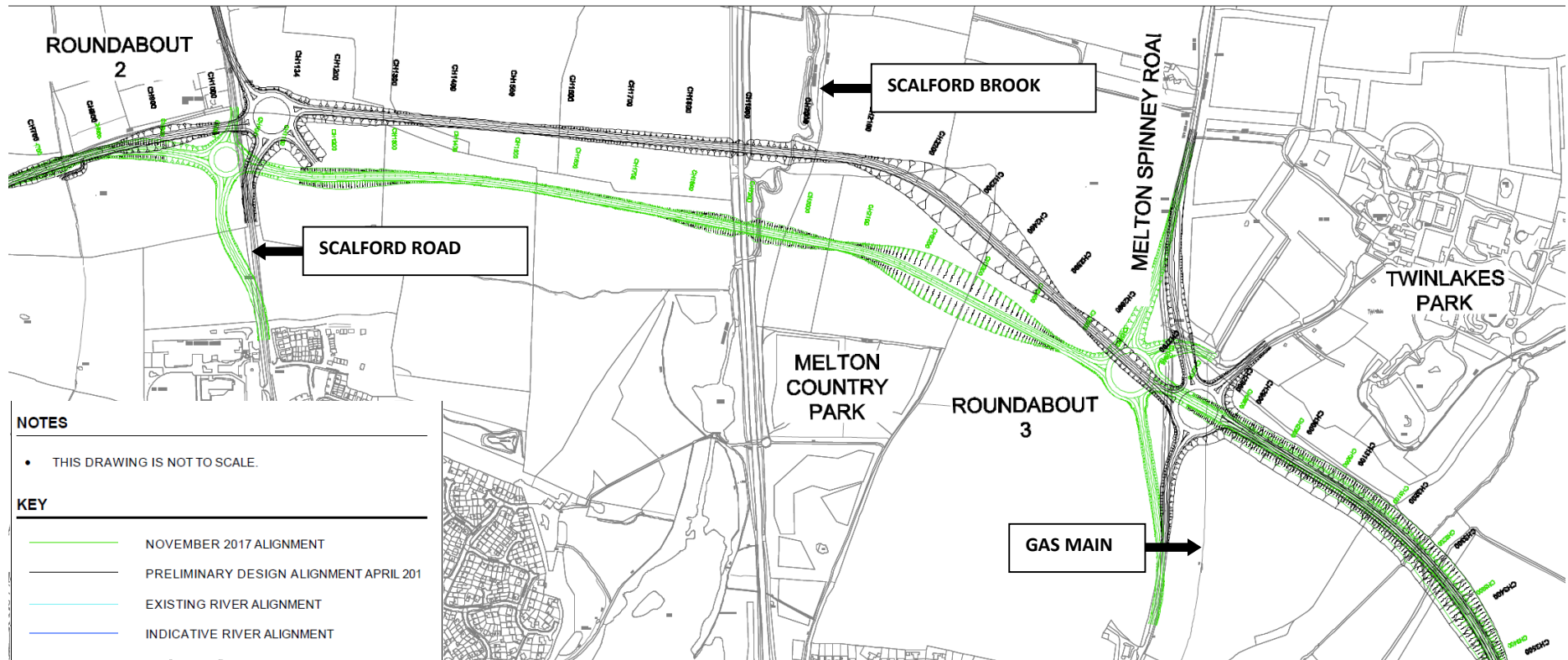


Fig. 1 Crossing the River Eye

- Power lines
- River Eye SSSI
- Canal
- Dwellings



## Fig. 2 Land between Scalford Road and Melton Spinney Road



# The Preferred Route



- ❑ Development of the River Eye diversion option is still subject to further discussion and agreement with Natural England and relevant landowners.
- ❑ Construction cost
  - The increased length of road (60m) due to changes between Scalford Road and Melton Spinney Road.
  - Current proposal for a reduced River Eye Bridge Span (than costed for OBC)
  - Powerline diversion no longer required
- ❑ Northern Sustainable Neighbourhood

## **May 2018**

DfT Large Local Majors Fund announcement

SCG May 29<sup>th</sup> – Planning application

## **June 2018**

Scrutiny June 28<sup>th</sup> – Planning application

## **06 July 2018**

Cabinet decision on approval of submission of planning application

## **August 2018**

Submission of planning application

(16 wk. determination)

Public exhibition

## **July – October 2018**

Preparation of statutory orders

## **To July 2020**

Detailed design, Making of orders,  
possible public inquiry, land take



- ❑ Agreement with the Director's recommendation of Preferred Route.
- ❑ The Preferred Route will be made public via a press release and the scheme webpage
- ❑ Update meetings have already been held with owners of land associated with key change locations but all landowners will be notified concurrently with the press release.